

| | | |
|---------------|-------------------------------------|------|
| PART NUMBER | | REV. |
| LCM-X04002DXX | | |
| REV. | E.C.N. NUMBER AND REVISION COMMENTS | DATE |

| P/N PREFIX/SUFFIX TABLE | | |
|-------------------------|-----|-------------------------------------|
| LCM-X | DXX | DESCRIPTION |
| STANDARD | S | SR STN, REFLECTIVE |
| | | SF STN, TRANSFLECTIVE(W/ BACKLIGHT) |
| HIGH TEMP. | H | TR TN, REFLECTIVE |
| | | TF TN, TRANSFLECTIVE(W/ BACKLIGHT) |

CAUTION: STATIC SENSITIVE DEVICE
FOLLOW PROPER E.S.D. HANDLING PROCEDURES
WHEN WORKING WITH THIS PART.

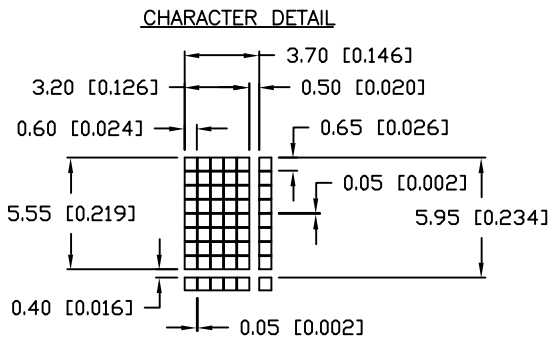

| TYPE | DIM. | A | B |
|----------------|------|------|-----|
| WITH BACKLIGHT | | 12.7 | 8.7 |
| NO BACKLIGHT | | 8.8 | 4.7 |

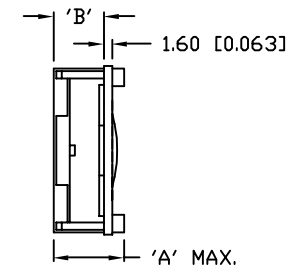
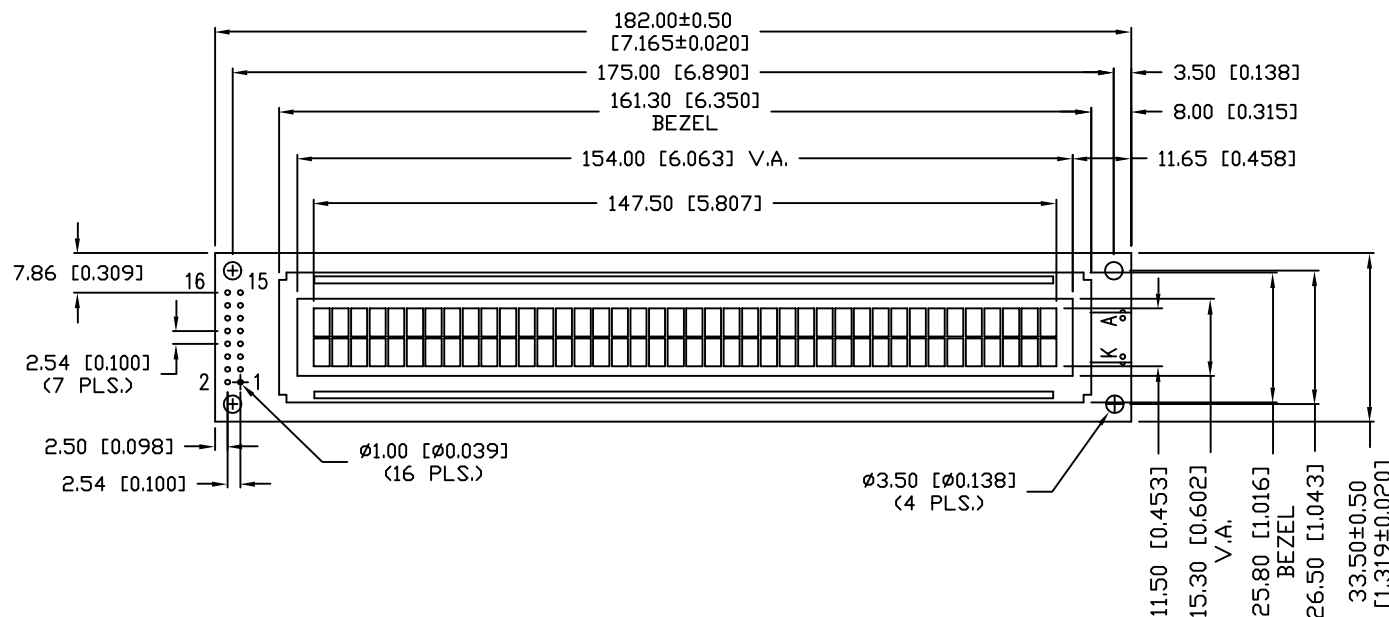

UNCONTROLLED DOCUMENT
*UNLESS OTHERWISE SPECIFIED TOLERANCE IS ±0.25mm (±0.010")

| | | | | |
|---|------------------------------|--|--|--|
| REV. | PART NUMBER LCM-X04002DXX | CONFIDENTIAL INFORMATION THE INFORMATION CONTAINED IN THIS DOCUMENT IS THE PROPERTY OF LUMEX INC. EXCEPT AS SPECIFICALLY AUTHORIZED IN WRITING BY LUMEX INC., THE HOLDER OF THIS DOCUMENT SHALL KEEP ALL INFORMATION CONTAINED HEREIN CONFIDENTIAL AND SHALL PROTECT SAME IN WHOLE OR IN PART FROM DISCLOSURE AND DISSEMINATION TO ALL THIRD PARTIES. | LUMEX INCORPORATED 290 E. HELLEN ROAD PALATINE, ILLINOIS 60067 PHONE: 1-847-359-2790 WEB: HTTP://WWW.LUMEX.COM | |
| 5.55mm CHARACTER HEIGHT, 5 x 8 DOT MATRIX, 40 x 2 LCD CHARACTER MODULE, 1/16 DUTY, 1/5 BIAS. | | RELIABILITY NOTE OUR MANY YEARS OF EXPERIENCE DATA ACCUMULATION INDICATE THAT SOLDER HEAT IS A MAJOR CAUSE OF EARLY AND FUTURE FAILURE. PLEASE PAY ATTENTION TO YOUR SOLDERING PROCESS. | DRAWN BY: SA/BC | CHECKED BY: APPROVED BY: DATE: 9-30-98 |
| | | | | PAGE: 1 OF 2 SCALE: N/A |